



Innovative Partnerships Program

Lisa Lockyer, Acting Deputy Director

Lisa.L.Lockyer@nasa.gov

October 20, 2005

Agency Reliance on Outside Innovation

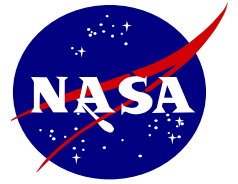

- “Many of the technical challenges that NASA will face in the coming years will require innovative solutions...NASA will need to leverage the ideas and expertise resident in the Nation’s universities and industry.” (The Vision for Space Exploration, February 2004)
- “....many innovative technologies are developed annually by American business. Many of these breakthroughs occur in fields unrelated to space, yet potentially have direct application to many aspects of, and problems attendant to, space flight.” (The Report of the President’s Commission on Implementation of U.S. Space Exploration Policy by Pete Aldridge, June 2004)

Red Planet Capital

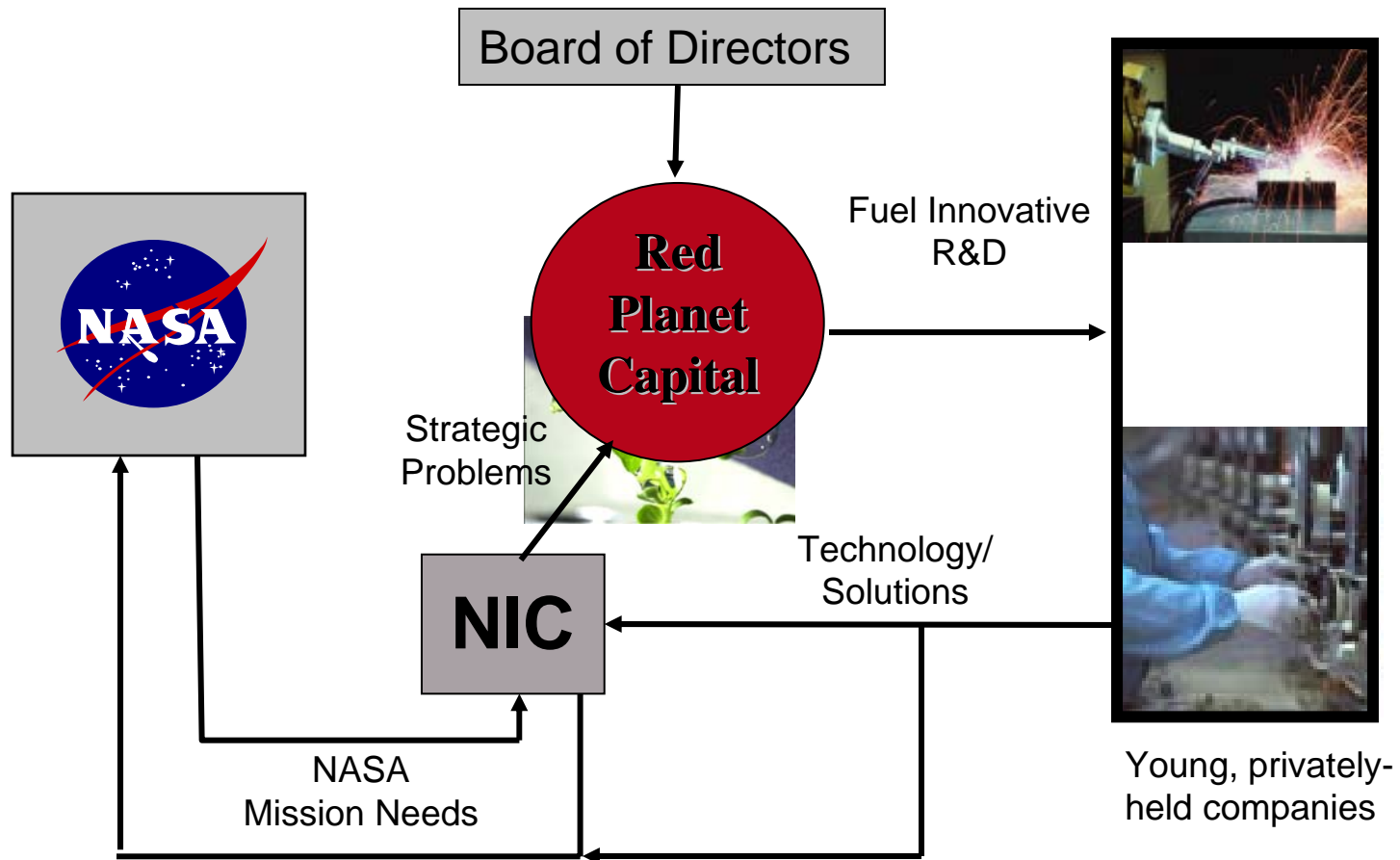

Red Planet Capital

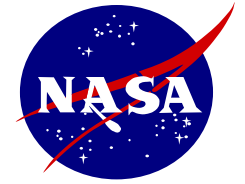

- Red Planet Capital focus:
 - Nanotechnology
 - Robotics
 - Intelligent Systems
 - High-speed networking and communication
- Current Mission Needs Statements:
 - Innovative Human Enhancements for Exploration
 - Water Recycling, Reuse, Reduction
 - In Situ Fabrication of Replacement Parts Technology
 - Environmental Monitoring, Control and Revitalization
 - Communications and Data Systems

Access to Land – NASA Research Park

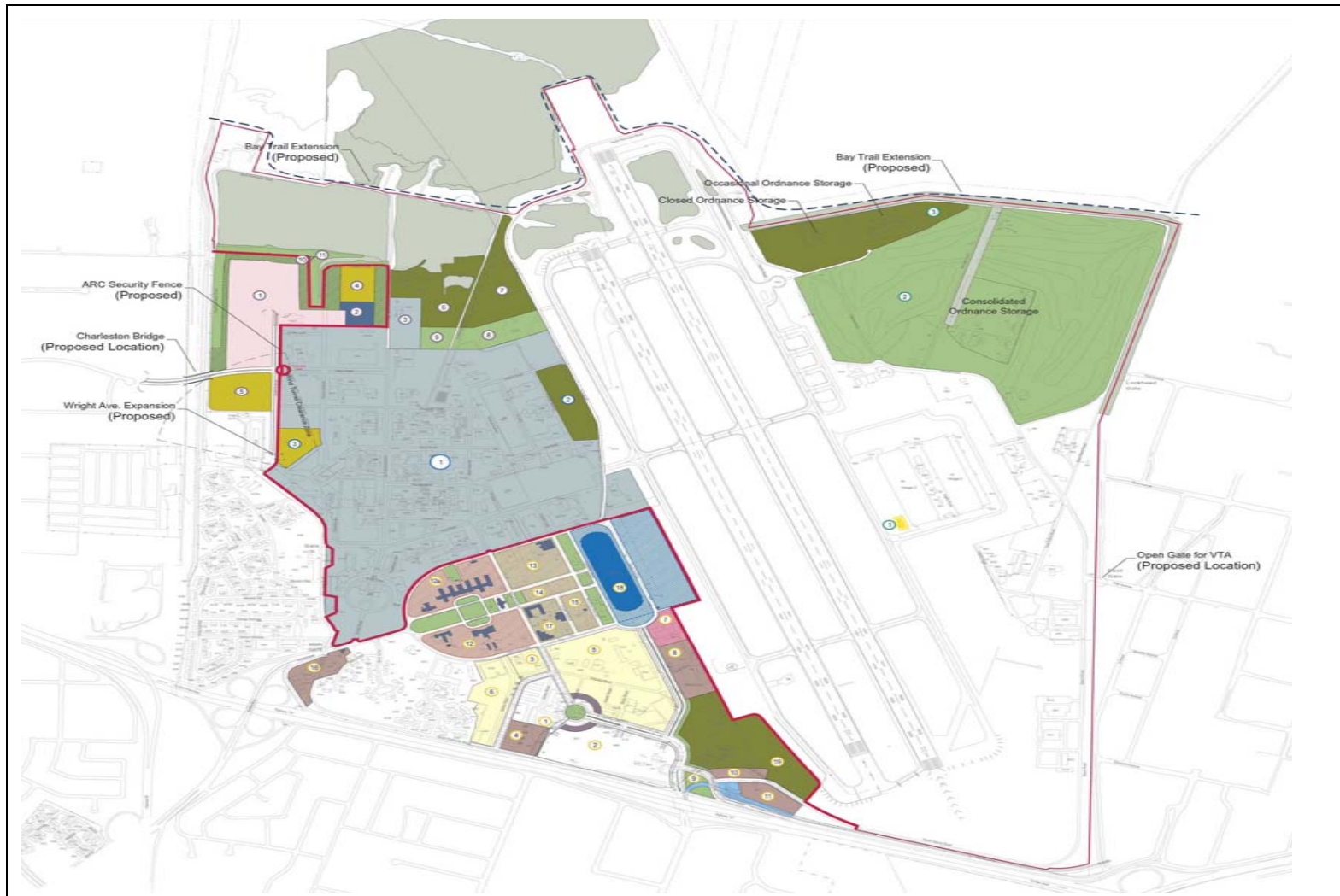

NRP Industry Partners



- Aprion
- Arachi, Inc.
- BluPoint Global
- Changene
- Conceptlabs
- Defouw Engineering
- Digiproofs, Inc.
- e4Xchange
- InformArt/GaryAir
- Inland NW Space Alliance (INSA)
- Intelligent Inference Systems, Corp (IIS)
- IntelligenTek, Corp.
- ION America Corp.
- Intrinsyx
- Jivalti
- Jumping Beans, Inc.
- Kentucky Science & Tech. Corp.
- Norman B. Houge, Inc.
- NXAR LLC
- Ozen Engineering, Inc.
- Photozig
- Pragati Synergetic, Inc.
- Tibion
- UAV Collaborative
- Venezia Maintenance and Construction
- Western Disaster Center